

Gear Coupling With Pin Elastomer and Brake Wheel (ZLL Series)

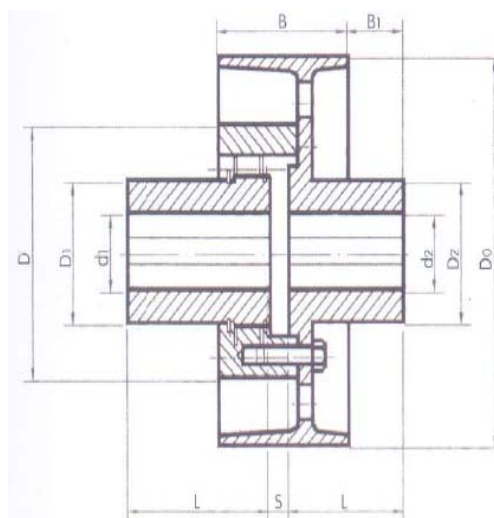

Parameters

Model	Nominal Torque Tn/N.m	Limited Rotational Speed [n] (r/min)	Shaft Hole		D0	D	B	Rotational Inertia (kg.m ²)	Weight (kg)
			Diameter	Shaft Hole Length Y, J1					
			d1,d2	L,L1	(mm)				
ZLL1	250	4000	16-38	42-82	160	98	68	0.022	7
ZLL2	630	3800	25-48	62-112	200	124	85	0.063	12.6
ZLL3	1600	3000	40-70	84-142	250	166	105	0.24	30.4
ZLL4	4000	2400	50-75	84-142	315	214	132	0.65	52.4
ZLL5	6300	1900	60-95	107-172	400	240	168	1.63	81.3
ZLL6	10000	1500	70-120	107-212	500	280	210	4.4	139.8
ZLL7	16000	1200	80-130	132-252	630	330	265	12.8	257
ZLL8	25000	1050	90-150	132-252	710	370	298	20.9	331
ZLL9	31500	950	100-170	167-302	800	384	335	33.5	424

Note

1. Weight and rotational inertia are calculated according to the combination type of Y/J₁ axle holes and the minimal axle hole.
2. During short-time overload, the value shall not be more than two times of nominal torque Tn.