

## TGL Curved-Tooth Coupling

### Description

This shaft coupling is suitable for connecting two horizontal axis of the shaft system. It is with certain relative deviation compensation performance for two shafts. The nominal transmitting torque is 10 KN.m to 2500 KN.m.

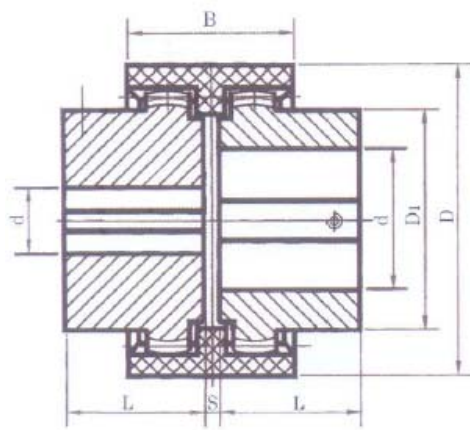

I 型

I model

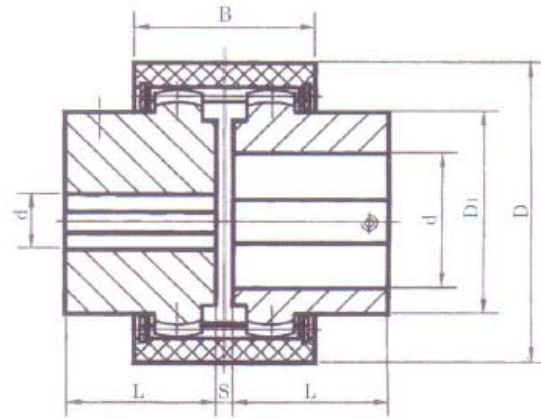

II 型

II model

### Parameters

Model	Rotational Torque $T_n$ / (N.m)	Limited Rotational Speed [n] / (r-min)	Shaft Diameter $d_1, d_2$	Shaft Hole Length $L_{J1}$	D		D1		B		B1		S	d	Weight (kg)		Rotational Inertia $I$ / (kg·m <sup>2</sup> )	
					A and B Type	C Type	A and B Type	C Type	A and B Type	C Type	A and B Type	C Type			A and B Type	C Type	A and B Type	C Type
TGLA1 TGLB1	10	10000	6, 7	16	40	-	25	38	-	17	-	4	M5	0.2	-	0.00003	-	
			8, 9	20														
			10, 11	22														
			12, 14	27														
TGLA2 TGLB2	16	9000	8, 9	20	48	-	32	38	-	17	-	4	M5	0.278	-	0.00006	-	
			10, 11	22														
			12, 14	27														

			16, 18, 19	30													
TGLA3			10, 11	22													
TGLB3 31.5	8500		12, 14	27	56	58	36	42	52	19							0.000
TGLC3			16, 18, 19	30							24	4	M5	0.482	0.533	0.00012	15
			20, 22, 24	38													
TGLA4			12, 14	27													
TGLB4 45	8000		16, 18, 19	30	66	70	45	46		21	26	4	M8	0.815	0.869	0.00033	4
TGLC4			20, 22, 24	38					56								
			25, 28	44													
TGLA5			14	27													
TGLB5 63	7500		16, 18, 19	30													
TGLC5			20, 22, 24	38	75	85	50	48		22	27	4	M8	1.39	1.52	0.00072	88
			25, 28	44					58								
			30, 32	60													
TGLA6			16, 18, 19	30													
TGLB6 80	6700		20, 22, 24	38													
TGLC6			25, 28	44	82	90	58	48	58	22	27	4	M8	2.02	2.15	0.0012	5
			30, 32, 35, 38	60													
TGLA7			20, 22, 24	38													
TGLB7 100	6000		25, 28	44													
TGLC7			30, 32, 35, 38	60	92	100	65	50	60	23	28	4	M8	3.01	3.14	0.0024	7
			40, 42	84													
TGLA8			22, 24	38													
TGLB8 140	5600		25, 28	44													
TGLC8			30, 32, 35, 38	60	100	100	72	50	60	23	28	4	M8	4.06	4.18	0.0037	9
			40, 42, 45, 48	84													
TGLA9			25, 28	44													
TGLB9 355	4000		30, 32, 35, 38	60													
TGLC9			40, 42, 45, 48, 50, 55, 56	84	140	140	96	72	85	34	41	4	M10	8.25	8.51	0.0155	6
			60, 63, 65, 70	107													
TGLA10	710	3150	30, 32, 35, 38	60	175	175	128	95	95	45	45	6	M10	16.92	17.1	0.052	5
TGLB10			40, 42, 45, 48, 50, 55,	84													

48, 50, 55,

